

APE Diesel hammer check list



Date: _____ Sales Order Number: _____ APE S/N: _____
 (must have sales number prior to all work)

Guiding set up for what size leads? Measure width of guides and height of guides. For example: 8" by 26" or 10 3/4" by 38"

Make sure this unit gets a standard tool box with spare grease in the tool box along with a grease gun. Please put a manual for the hammer in the tool box also. To add additional items to this list please contact John White at APE.

Step by step procedures for all APE diesels

- Steam clean hammer (if not new)
- Remove anvil and slide out piston for inspection
- Steam clean piston and anvil
- Check piston rings and catch ring for wear
- Inspect all ring lands and grooves for damage
- Rotate rings to make sure they are not jammed
- Inspect entire piston for damage from trip
- Grind down any high spots caused by trip
- Clean cylinder and inspect for damage
- Check lower cylinder sleeve for movement
- Check grease zerts to see if they are clogged
- Mic the bore, piston, and anvil using data chart
- Inspect inner cylinder end ring on anvil
- Inspect anvil where piston hits top of anvil
- Inspect anvil for cracks where it strikes plate
- Check condition of rubber rebound ring
- Check anvil retainer bolts for damage
- Check lower cylinder for cracks or damage
- Replace all fuel lines with good hose clamps
- Inspect inner cylinder end ring on anvil
- Inspect anvil where piston hits top of anvil
- Inspect anvil for cracks where it strikes plate
- Check condition of rubber rebound ring
- Check anvil retainer bolts for damage
- Check lower cylinder for cracks or damage
- Check cable on fuel pump
- Check to see if stop valve is not bent

Step by step procedures for all APE diesels

- Drain fuel tank
- Clean fuel tank filter
- Installed in line fuel filter
- Removed, cleaned, serviced and re-installed fuel pump
- Removed, cleaned, serviced and re-installed oil pump

Trip Mechanism

- Checked trip pawl for wear
- Checked trip lever for wear
- Checked trip dogs on hammer for wear
- Checked trip leaf spring to see if it is still in good condition
- Checked trip gibs for wear
- Checked trip guide tubes for cracks or wear
- Checked trip guide top stops for cracks or problems
- Checked trip links for wear
- Checked to see if this hammer needs a hyd trip on it
- Checked to see if contractor is driving batter piles

Testing Hammer

- Installed clean fuel in fuel tank
- Installed clean fuel in oil tank
- Removed blow out plug and dropped piston to flush unit
- Start hammer and run on all four settings
- Prepare for shipment- travel plug, exhaust port covers, etc.

Fuel pump check list: Circle items to confirm that you checked these parts for wear.

Remove pump and disassemble. Clean all parts. Check the following items for wear.



Guide Sleeve

Check surface where pump lever makes contact with back of sleeve. Replace with new part if worn even a little bit.



Pump lever

Check the pin hole for wear. Check the two contact surfaces for wear. Replace if worn.

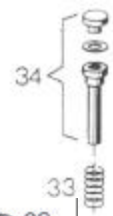

Pressure peice complete

Check the top piece for wear. Replace if worn. Check spring.



Pump element

Check pump piston fit into bore. Pump will not work properly if there is even a slight amount of slop. Replace these parts if any signs of wear can be seen.

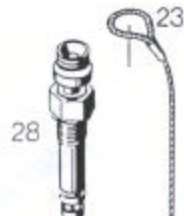

Stop valve, complete

A common failure of this valve is that it gets struck by something and bends. The second most common problem is the o-ring melts. Replace if bent. Check the o-ring. Replace cable if worn out.



Suction Valve, complete

This check valve is a common problem. Make sure this valve is clean and the fitting is not damaged. Make sure the sealing ring is in good condition.



Fuel regulating assembly

Check all moving parts for wear. Replace any parts that show any signs of wear.